



# TO LET

**Highfield Road, Feltham, TW13 4GR**  
**£1,300 Per Calendar Month**

**DBK**  
ESTATE AGENTS

- Available To Rent Immediately!
- One Double Bedroom
- Large Reception Room/ Diner
- Fitted Wardobes
- Prime Location
- Second Floor Apartment
- Modern Fitted Kitchen
- Family Bathroom/ WC
- Secure Entry System
- Feltham Station 0.3 miles

452 sq.ft. (42.0 sq.m.) approx.

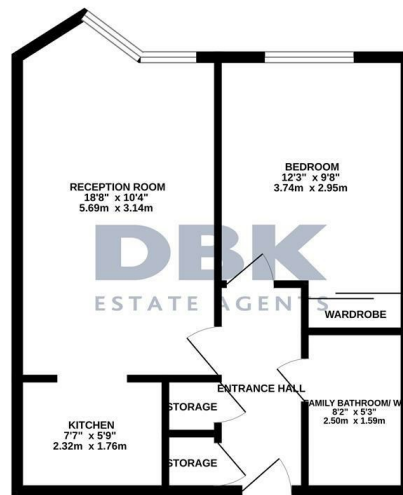

TOTAL FLOOR AREA - 452 sq.ft. (42.0 sq.m.) approx.

While every effort has been made to ensure the accuracy of the floorplan contained herein, measurements of doors, windows, rooms and any other items are approximate and no responsibility is taken for any errors, omissions or mis-statements. This plan is for illustrative purposes only and should not be used as such by any prospective purchaser. The layout, systems and appliances shown have not been tested and no guarantee can be given for their operation or efficiency can be given.  
Made with Metaplan C2024

## THE PROPERTY

Available To Rent Immediately!

A fabulous second floor apartment located within the heart of Feltham, sprawling circa 452 sq.ft. The property consists of a double bedroom, a large reception room/ diner, a modern fitted kitchen and a family bathroom suite. Complementary to this is a private terrace, ample storage and a secure entry system.

Conveniently located just High Street, Feltham the property falls within an ample array of nearby well-regarded amenities including supermarkets, Cineworld Cinema and local restaurants/ bars. For transport, just minutes a walk is Feltham BR Station and for those commuting by vehicle the A30 and A316 can found within a short drive. Reputable schools such as Cardinal Road Infant and Nursery School and Reach Academy Feltham both scoring OUTSTANDING by OFSTED can be found within 0.5 miles of the property.